

BAOBAB S TABLE

designed by Resol Studio

DESCRIPTION

Baobab S table for indoor and outdoor use. Premium range MDPE base manufactured with rotomolding technology for indoor and outdoor use. Protection against UV rays. Possibility of configuring as a stool. Easy assembly.

UNDER CERTIFICATION PROCESS

UNEEN581-1, UNEEN581-3, BIFMA X5.5

Ø40 / Ø50 cm
Ø15.7 / Ø19.7 in

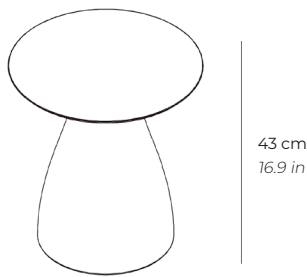

CHARACTERISTICS

Base Weight 1,5 Kg. / 3.31 lb.

	Packaging (cm)	Packaging (in)	m ³	ft ³	Peso Br. (kg)	Gross We. (lb)
📦 1x	30 x 30 x 48	11.8 x 11.8 x 18.9	0.04	1.5	3.5	7.7

BASE COLOR



HPL BOARD

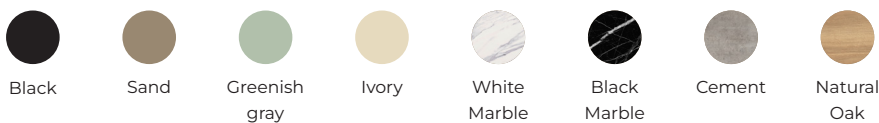

UPHOLSTERED



sunbrella
Grammage
275 gr/m²

STABILITY

5.5 Kg ballast to provide stability, sold separately.

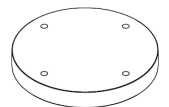

R *Recycled

SUSTAINABLE PRODUCTION - ENVIRONMENTAL COMMITMENT



Resol invests money and resources for research and search for more sustainable processes.



All Resol products are produced with a responsible use of water.



Dangerous chemicals are not used under any circumstances during production.



At Resol, all waste is managed in a sustainable and responsible way.

